

Moulded Parts 234A111 to 234A152 (rectangular, 90° side entry, D-SUB)

These moulded parts or heat shrink boots are used for mechanical protection and cable strain relief. This version is ideal for cable harness applications where cable branches and breakouts are required. Our moulded parts combine an easy and quick installation with high electric strength, mechanical toughness and chemical and environmental resistance. These moulded parts are with or without coating available.

As supplied

After heating

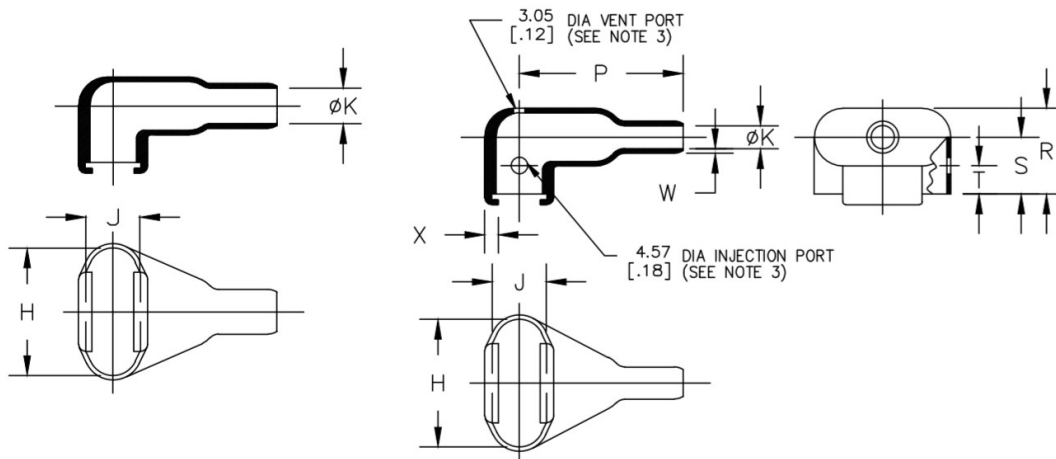

Dimensions in mm

Injection and vent port available only on request

Part number	Inside diameter (coating reduces Ø max. 1.5mm)						P	R	S	T	W	X	Fits to
	As supplied			After heating									
	H	J	K	H	J	K							
234A111	20.3	10.7	7.9	20.3	10.7	4.1	27.9	18.5	12.7	7.87	1.02	3.05	DE-9
234A121	28.2	10.7	10.2	28.2	10.7	5.3	35.1	18.8	12.7	7.87	1.02	3.05	DA-15
234A132	42.2	10.7	14.0	42.2	10.7	6.4	47.5	20.1	14.2	7.87	1.02	3.05	DB-25
234A142	58.7	10.7	17.3	58.7	10.7	7.9	59.7	20.1	14.2	7.87	1.02	3.05	DC-37
234A152	57.9	13.7	19.1	57.9	13.7	9.1	63.2	26.4	17.5	7.87	1.02	3.05	DD-50

Material (not all combinations available)

Ordering Code	Material	Operating temperature range
-3	Polyolefin, semi-rigid	-55°C to +135°C
-4	Polyolefin, flexible	-55°C to +135°C
-12	Fluoroelastomer, flexible	-55°C to +200°C
-25	Elastomer, fluid resistant	-75°C to +150°C
-100	Polyolefin, halogen free	-30°C to +105°C

Coating, Adhesive

Ordering code	Material	Operating temperature range
/42	Polyamide, hot-melt	-20°C to +60°C
/86	High performance, hot-melt	-55°C to +120°C
/225	Epoxy/Polyamide	-75°C to +150°C

Colour

Ordering Code	Colour
-0	Black